

THE BUNGONIA TIMES

The Community Grape Vine

Circulation 290

Vol. 9-No 4

May, 2000

CONTACTS:	Pauline Dickson	4844 4202	Norma Walters	4844 7129
	Cherie Jenkins	4822 4241	Moirra McGinity	4844 4266
	Gail Waddell	4844 4252		

FAX:	Cherie Jenkins	4822 0517	Moirra McGinity	4844 4266
------	----------------	-----------	-----------------	-----------

DATES TO KEEP IN MIND

May 2000

5 th	Friday	Park Trust Meeting 7.30 pm
8 th	Monday	Progress Meeting 7.30 pm
18 th	Thursday	CWA Meeting 10 am
12 th	Friday	Bush Fire Brigade Meeting 7.30 pm
13 th	Saturday	Fire Brigade Maintenance (B Atkinson & J Edwards)
22 nd	Monday	Bungonia Times Deadline 12 noon
27 th	Saturday	Fire Brigade Maintenance (T Jessep & D Jenkins)

ABOUT OUR NEWSLETTER

Advertising Charges:

For Sale/Wanted	\$2.00	Half Page	\$10.00
(Maximum 3 lines)		Full Page	\$20.00
Business Card Size	\$3.00	Insert: ready for inclusion	\$10.00
Quarter Page	\$5.00	Double Page at Discount	\$30.00

Bungonia Times Deadline : 12 noon Monday 22nd May, 2000.

Please ensure that all contributions are received by the above time and date. For late entries please contact Cherie Jenkins on 4822 4241.

Home Delivery by Mail: Send your mailing details to Pauline Dickson, 'Netherfield', 243 Lumley Road, Bungonia 2580 with a cheque for \$11.00 to cover the cost of postage for a year. Please make your cheques payable to "The Bungonia Times".

***This issue was printed by Business Requisites Russell Lane,
Goulburn***

Bungonia Times Raffle: Thanks to all those people who helped our newsletter survive another few months by buying tickets in our raffle. We raised a massive \$432.00 which was needed urgently as we were totally 'broke'. Its great to see the community support our newsletter, thank you again. The winners were:

- 1st Monica Hunt, Eleanor Heights in Sydney
- 2nd Colleen Bowden, Goulburn

RAINFALL AND TEMPERATURE

March Temperature: Maximum: 14 Minimum: 26.5
February Rainfall: 128 mm

The temperature and rainfall come courtesy of Dan Smillie.

BUNGONIA BUSHFIRE RURAL BRIGADE

Emergency Numbers: 4821 1914 Andy Smith: 4821 5009 or Bungonia Base

NEXT MEETING: Friday, 12th May, 2000 7.30 pm at the fire shed.

Contacts: **President** – Ian Maher 4844 4387 **Secretary** – Bob Atkinson 4841 1575
Captain – John Edwards 4821 5489 **Treasurer** Paul Bayliss 4844 4359

Captains Report

April was quiet apart from a dumped car being set on fire on Jarrara Road. Thanks to Cherie & Dennis Jenkins and Charlie Bowker in helping me with that fire, also thanks to the quick thinking Priests at the Greek Monastery, the possibility of a scrub fire (which could have easily caused a large bush fire) was quickly under control after he called the fire captain and cleared ground around the burning vehicle.

On behalf of the Bungonia Rural Fire Service, I would like to thank Ray & Ruth Dole for what they did before and on Market day to help raise money for the brigade. Every year they run the stall for the fire service.

A VERY BIG **THANKS** TO BOTH OF YOU!!

Also I would like to thank Andy, Eileen and Bernie Smith for running the raffle on market day. The raffle raised \$275.00, thanks to all those who helped by buying tickets. The winners were:

- 1st Cherie Jenkins
- 2nd Ray Dole
- 3rd Garry Starr
- 4th Sue Bowker

BUNGONIA BUSHFIRE RURAL BRIGADE

Remember when burning off, be careful!

Also remember with the cold weather quickly coming, lets remember to

- CHECK YOUR CHIMNEYS
- CLEAN YOUR FIRE PLACES

Lets prepare for NO HOUSE FIRES THIS SEASON!

John Edwards *Captain* 4821 5489

Chimney Checking: The brigade is willing to come and check and clean your chimney for a small donation. Its vitally important that your chimney is cleaned on a regular basis as turning your fire down allows a build up of unwanted tar inside the flue.

Maintenance Roster

If you can't make it on that day, organise with your partner to do it on another day or if you are unable to do it at all, please phone the captain.

13th May Bob Atkinson 4841 1575

John Edwards 4821 5489

27th May Tim Jessep 4844 4275

Dennis Jenkins 4822 4241

10th June Working Bee to start building new office in shed, as well as truck maintenance all welcome

More names are needed for the roster to help us with the maintenance of the vehicles and equipment over the winter months, this will only take a small amount of your time one Saturday, Sunday or what ever day you and your roster partner decide. You can put your name down via Cherie Jenkins (for inclusion in the Bungonia Times as a reminder) or phone Andy on Bungonia Base or myself and give us a date you would prefer to help.

PATCHWORK & QUILTING CLASSES

Contacts: Pauline Dickson 4844 4202 or Cherie Jenkins 4822 4241

Every Monday at 9 am to 12 midday at the Bungonia Village Hall. If you would like to learn the art of patchwork and quilting, contact Pauline Dickson on 4844 4202 or Cherie Jenkins 4822 4241.

Remember, anyone can learn at any age. We enjoy helping each other and learning new are varied ways of doing quilting.

Classes are only \$1.00 which helps pay for tea and coffee and if our teacher comes, we pay \$4.00 extra to help cover her travelling costs. Everyone is welcome.

CHURCH NEWS

CHRIST CHURCH – BUNGONIA

Enquiries: Peter Dennelly 4822 4845
Cherie Jenkins 4822 4241
Minister: Rev Nick Hearnshaw 4821 4976

Keyboard: Judith Dennelly & Brad Griffiths

Next Communion Service Sunday May 14th, 2000

Communion is held every 2nd Sunday. There will be no church meeting on the 5th Sunday of the month as we all meet in at St Nicholas Church in Kinghorne Street Goulburn.

Group Study Sessions

Tuesday nights at 7.30 pm at Dawn & John Edwards home. Come along and enjoy a night with a difference. Phone Dawn for information 4821 5489 or Cherie 4822 4241.

GAS Group (Growth and Sharing)

Held at the Dennellys, contact Judith or Peter on 4822 4845.

May Cleaning and Flower Roster The Norris Family

June Cleaning and Flower Roster: The Brooks Family

ST. PATRICKS - MARULAN

Mass is celebrated at 4 pm every Sunday

Priest: Father Kevin Brannelly 4821 1022

Mass on Easter Sunday will be at the usual time 4pm.

ST. STEPHEN'S UNITING CHURCH – MARULAN

Enquiries: Maureen Eddy 4841 1648

Services are held every 2nd Sunday at 9 am.

Ladies Fellowship every 3rd Monday at 1 pm – Contact Jill Farnsworth 4841 1849

Kids Club every Friday afternoon at 3.30 pm – Contact Dorothy Weeks 4841 1650

ALL SAINTS' - MARULAN

Services are held every 1st Sunday at 9 am

ST. BARTHOLOMEW'S - WINDELLAMA

Enquiries: 4821 3631

Communion Services are held every 4th Sunday at 11.30 am.

COUNTRY WOMEN'S ASSOCIATION

President: Shirley Smith 4821 5606 Secretary: Ruth Dole 4844 7179
Treasurer & Publicity Officer: Colleen Cooper 4821 1856

NEXT MEETING: Thursday 18th May, 2000 10.00 am

Two of our members travelled to Marulan Branch recently for an International Day Luncheon and heard a very interesting guest speaker on Hungary, our Country in Study for this year.

Members are helping with preparing and serving lunches during the State Conference to be held in Goulburn during early May.

For the first time in many years our branch will have a Delegate attending the conference.

Colleen Cooper – Publicity Officer, CWA Bungonia

PARK TRUST

President: Frank McGinity: 4844 4266 Secretary: Karen Fabri: 4844 4382
Treasurer: Diana Moran : 4844 4234

Next meeting Friday 5th May, 2000, 7.30 pm

War Memorial. The upgrading has been completed and the gate posts removed.

Playground Equipment. We are just awaiting delivery of a Spring Rocker.

Tennis Courts: Karen Fabri 4844 4382

Barbeque area: Col Parker and Russell Koenig have been repairing, and if necessary, painting, BBQ tables, the grass around the area has been cut and wood for the BBQ supplied.

The Park Sign: This will be erected as soon as time permits.

Donations of any kind, from weed-poison, timber, native plants and trees, labour or money would be gratefully accepted.

Keep watching the park for all these great improvements.

BUNGONIA PROGRESS ASSOCIATION

President: Joe Leatherbarrow Secretary: Diana Moran 4844 4234
Treasurer: Narelle Walters 4844 7007 Hall Hire: Moira McGinity 4844 4266

NEXT MEETING: 7.30 pm Monday 8th May, 2000 at the Hall.

Recipe Book: This is still on hold.

Market Day. Easter Saturday, 22nd April was a very successful day with a record number of stalls and perfect weather.

Kitchen: We need a couple of people to serve in the kitchen on Market Day. If you can help out please Contact Diana Moran 4844 4234

Anzac Day: about 50 people gathered at the War Memorial to commemorate Anzac Day and to remember and to be grateful to those who served our country in time of crisis. The work on the Memorial was completed the week prior to Anzac Day. After the service we all went to the hall for a cup of tea.

Septic Tanks: The shire is holding a Septic Tank Inspection Day at the Bungonia Hall on Thursday 25th May and morning and afternoon tea will be provided by the Progress Association for a small fee. If sufficient people want lunch, Progress will put on a sausage sizzle for a reasonable charge. Please phone Moira if you would like lunch (4844 4266).

BIRTHDAYS IN MAY

May
06 Andrew Farrugia
09 Margaret Davey
26 Margaret Symonds
30 Christopher Moran

Birthstone: Emerald (Success in Love)

Flower: Lily of the Valley

COMMUNITY NOTICE BOARD

Marulan Garbage Depot – Hours are: Friday, Saturday and Sunday
From 1st June to 31st September – 9 am to 5 pm
From 1st October to 31st May – 8 am to 5 pm.

FOR SALE:

Head Bale for cattle crush, solid steel construction \$250.00
Phone Carl or Anne 4844 4225

LOST:

Green canvas cover from a tool box, between Inverary Road and Jacqua Road.
Phone Arthur on 4844 4242

Lost: Have you seen "Pixie" – Tabby desexed male cat, small adult, timid and shy but very affectionate. Disappeared, upset by a new arrival. We miss him terribly. Please contact Cynthia or Peter Harris on 4844 4275 (Mountain Ash Road – but Pixie may have travelled some distance).

The Argyle Society, well known in Goulburn and district will be presenting the Gilbert and Sullivan comic operetta, "The Pirates of Penzance" during May at the Kenmore Theatre. A talented and enthusiastic cast wend their way through a highly improbable story to delightful music. Leading roles are taken by Elizabeth Oldham, whose magnificent voice and wealth of experience will be appreciated by audiences, Steve Hart as Frederick, and Simon Hughes as the Pirate King. The chorus and orchestra include old members of the society and a number of new comers, coming from the Goulburn area and the Southern Highlands. Why not enjoy a pleasurable night out, and set aside a Friday or Saturday night in May. Performances start at 7.30 pm, tickets are \$15 (\$10 for student concession) will be on sale at Colless' Newsagency in Goulburn.

Births

Scott & Susanah Byrne are the proud parents of their first son, James Douglas, born on 16th April. Weighing in at 9lb 6oz and 55cm long, James is fighting fit. Denise & David Byrne, the proud grandparents, are grinning ear to ear. Congratulations Scott and Susie and Denise and David.

GARDENING IN MAY

This is the time of year when a lot of general cleaning up can be carried out in your garden.

With cooler nights, mildew which is a fungus, can be seen on the leaves of Dahlias, Hydrangea, Petunias, Delphiniums, Easter Daisies, Pumpkins and Cucumbers as well as some others but it is not worth spraying with a fungicide. Delphiniums and Easter Daisies can be cut back about 8cm, above ground and with Dahlias, cut the stems above the leaf node. If you cut between the nodes, the stems being hollow can fill with water and the bulbs can rot.

Any leaves covered with mildew should not be put in compost heaps as this fungus will spread through your garden when the compost is spread next season. Make sure you burn those leaves or put them in the bin as garbage.

This month many perennial plants such as Polyanthus, Russell Lupin and Delphiniums can be divided making sure when you replant them to dig some compost into the garden as well as a light dressing of complete fertiliser.

Vegetables to sow are very limited as any seedlings planted now lay dormant during the winter months. Broad Beans are excellent to plant now, they do very well in the cooler climate, but before sowing the seed only, give the bed a good dressing of garden lime.

Onion plants are available now as well in nurseries. Plant white and odourless onions only though. Onions need very little water, plenty of sun, good drainage and before sowing a light dressing of complete fertiliser.

Flower seedlings that can be planted now include Calendula, Stock, Wallflower, Alyssum, Poppy, Pansy, Viola and Verbena.

Another general clean up job is to lift Gladioli bulbs and store them in a box or hang them up in an airy shed.

Happy Cleaning Up Your Garden!

LIBRARY NEWS

OVERCOMING THE TYRANNY OF DISTANCE

Residents of Mulwaree Shire with Internet access can now visit their library from home. This is because the Southern Tablelands Regional Library, has just launched a new information service to answer people's information questions by e-mail. The service is available from the library's homepage, which is located at www.goulburn.nsw.gov.au/library. Just click on the "Have a question? " icon and complete the online form.

The library can help you with any question, and where possible will provide direct answers, however, some questions will be better answered by a list of appropriate sources of information available in the library's branches, or on the Internet. Lengthy research questions cannot be answered via this service, but we can advise you on appropriate resources that you may wish to inspect personally.

We will respond to your request within 48 hours and provide an answer as soon as practicable within 10 days. Requests will be answered via email.

The library hopes that this service will make it easier for our remote residents to get in touch with the library to get help with their information needs. So next time you have a question that needs an answer, look us up!

Goulburn Branch Library is open Monday, Wednesday, Friday: 10.00am to 6.00pm, Tuesday & Thursday: 10.00am to 7.00pm, Saturday: 10.00am to 5.00pm, Sunday: 2.00pm to 5.00pm. For further information please telephone 4823-4435.

Sylvia Brook, Goulburn Branch Officer-in-Charge.



40 RUBY STREET GOULBURN NSW 2580
Phone: (02) 4821 5050 • Fax: (02) 4822 1016 • Mobile 0419 612 046

CLEARING SALE

"AVON" Third Creek Road, Crookwell

Saturday, 20th May, 2000 from 10 am

Tractor, slasher, plant equipment, 2 sunbeam electric overhead gear, furniture, electrical, dishwasher, English crockery.

100's more goods.

Property sold, goods for outright sale.

Comprehensive list in Town and Country Magazine on 8th May 2000 or from Jim Brewer Property Sales on 4821 5050 (40 Ruby Street, Goulburn).

CLEARING SALE

"Mildare", Corrinyah Road (off Brisbane Grove Road) Goulburn

Saturday 27th May, 2000 at 12 noon

Goods include:

Tractor, many items of farm machinery and sundry plant, equipment.

Presented in excellent order, always shedded and looked after. Ideal for small farm (and Bigger) use.

Buyers can attend with confidence. No buyers premium.

For detailed list, see Town and Country Magazine, Monday 15th May, 2000 or from Jim Brewer Property Sales on 4821 5050 (40 Ruby Street, Goulburn).

INVERARY CREEK

LANDCARE GROUP INC.

PRESIDENT: K.M. COOPER.

02 4844 4214
2580

"INVERARY"
BUNGONIA.

FARM WALK.

RESOURCE CENTRE.

Constructed by voluntary labour and funded by the Shoalhaven C.M.C. enables the group to store all their equipment and display material in one location. Available for field days and any visiting groups, it offers a teaching facility, catering centre and displays of what the Group has achieved since 1992. Thanks to the initiatives of the group and funding many on ground projects have been completed, all aimed at the restoring the environment, enabling sustainable farm management for the future. Take a copy of these notes with you on the 60 minute return walk to help explain what we have achieved.

FOLLOW THE RED ARROWS.

WETLANDS.

The walk follows Inverary Creek -- a permanently wet, boggy area fed by spring water seeping from under the basalt cap covering a large area to the South. All the creek lines have been fenced out to exclude stock and planted with various tree species. The wet areas have now been completely colonised by the reed cumbungi, which is an excellent silt trap to control sediments on site, You will cross the creek at the Solar pump and have a closer look.

IMPORTANCE OF GENETICS IN P. RADIATA PLANTINGS.

- The emphasis where commercial tree plantings have been established is on P.radiata. There are many reasons for favouring the exotic species over natives. We would like from the outset to dispel the many myths and misconcepts about P.radiata which we believe is the best landcare tool for our harsh conditions of acid soil types and rainfall. This does not mean natives have been neglected -- over 100 Eucalypt species and many Acacia, Casuarina and other species have been trialled and used in woodlots and shelter areas. Radiata Pines have the following advantages:-
- Cheaper and easier to establish and offer a high financial return.
- Grow successfully on acid soils and even help reverse the acidity.
- They are not biological deserts, but improve the biodiversity and harbour a rich variety of bird and animal life.
- They are the best commercial species for this area..
- They have few predators and diseases.

- Reduce dryland salinity and will grow on saline scald areas.
- Use very little herbicide or pesticide over a 30 year rotation.
- Improve soil structure and organic matter.
- Over 70% of pine biomass remains after harvest unlike other crops or pasture which are removed when grazed or harvested.
- They are 5 times as efficient as mature native forests in trapping carbon, so reduce greenhouse.
- They are not a fire hazard -- not as great as Eucalypts or unmanaged pastures.

Now we should have convinced even the ardent "nativists" that radiata is not a bad species after all. The importance of genetics is well illustrated at the first stop. The GF7 on the left has poor form compared to the plantation on the right. Unlike most other species pine has had a lot of research and improvement over the past few years. It is always best to plant the highest genetic suitable to the area.

TIMBER AND STOCK SHELTERS.

Trees have been planted as a dual purpose to provide shelter and eventually harvest for clear wood logs. By having different age plantings and eventually second rotation after harvest, there will always be stock shelter. The plantings have been designed for maximum shelter for lambing paddocks.

PRUNING AND THINNING.

The final value of the forest depends on how it is managed. In this area there is no pulp wood market, hence all the return is from a final crop of clearwood logs. The first thinning from 1000 per hectare to 600 with a first lift of 2.2 metres is carried out at year 6-7. A second lift to 4.2 metres and a final lift to allow for a 6.2 metre log and thinning to 300 per hectare ensures all high quality logs.

SOLAR PUMP.

In an attempt to create an artificial wetland in the dry "Gully from Hell" a solar pump will transfer water up to 40 litres per minute. Once installed the solar pump costs nothing to run and is maintenance free.

THE GULLY FROM HELL.

This massive dry gully has been carved into the old Eocene landscape by erosion over the last few hundred years. In a quite unusual erosion process the damage is done by soil moisture in the sub soil rather than running water. The soils formed on these old sediments are highly sodic and very dispersable. Once the sub soils become wet it will dissolve away in suspension. Tunnelling is very evident.

The solution as we see it, lies in controlling the ground water. The whole catchment of 40 hectares has been planted with commercial forestry, which when harvested over a space of several years will be replanted for a second rotation. This solution will, we hope, stop the erosion process and eventually stabilise this scar on the landscape. In the meantime the land is being used in a sustainable way to provide income estimated at \$500 per hectare per year on otherwise useless land. We see forestry in these soils as a win win situation for both the landowner and the environment.

ACACIA TRIALS. (to be established in 2000)

A part from *P.radiata*, there is a possible niche market for other species. This trial of 10 of the better Acacias is aimed at measuring their performance for possible timber and firewood production. Previous trials favour *Ac. Mearnsii* and *Ac. Decurrens* both local species.

EROSION CONTROL AND TREE PLANTING.

This site was a very active gully reclaimed by fencing out and tree planting. Surface water has been diverted by a low contour bank. Gullies like this can be treated without extensive earthwork.

DIRECT SEEDING.

This is a cheap tree establishing method. A whole cocktail of mixed natives is seeded directly into sprayed out pasture.

This branch of Inverary Creek was once very active, much like the 'Gully from Hell'. Since fencing out, stock exclusion and seeding, the gully has now stabilised. The banks have battered themselves and good grass cover is growing on the gully floor. Willows and poplars, as well as *radiata* has been used to soak up spring water. This method of gully reclamation is relatively cheap and needs no earthworks.

WINDBREAKS.

These have been planted in a N-S pattern over the whole property for shade and shelter. This species *E. Acaciaformis* is one of the better ones for this area, giving shelter to ground level and being reasonably insect resistant. It will also grow on the heavy black basalt soils.

WETLANDS.

Along the creek below the flume is what we want to achieve on all wet creek lines. Despite the adverse criticism of willows, the species planted here are beneficial in stabilising the creek, using up surface water and providing a useful drought fodder reserve. These willows do not produce viable seed and as long as undesirable hybrids are not planted they pose no environmental risk.

We hope you have enjoyed this Landcare experience and leave with some new ideas you can use in your own situation. This is a sample of what Inverary Group has achieved with limited resources. Support the Landcare ideals toward sustainable land use for the coming millennium.

K.M. COOPER

Ahoy there! Your ship has just come in!

The Pirates of Penzance

Presented by The Argyle Society

KENMORE THEATRE

TARALGA ROAD

5th, 6th

12th, 13th

19th, 20th

26th & 27th MAY 2000

at 7:30 pm

ADULT : \$15 STUDENT (TO YEAR 12) : \$10

BOOKINGS AT COLLESS' NEWSAGENCY 02 4821 2068

For a rollicking night of entertainment!



WOLCO AUSTRALIA PTY LIMITED

Your Local Windellama Electrical Contractors

Serving the Area for Four Years

RURAL DOMESTIC SOLAR COMMERCIAL INDUSTRIAL

Local Contractor so NO TRAVELLING TIME or MILEAGE COSTS

Now Area Agent for Birkenhead Solar Power

We can supply all your power needs at CITY PRICES

FREE QUOTES

WOLFGANG FEHLAU

'TWIN CREEKS' SPA ROAD WINDELLAMA

Telephone/Fax (02) 4844 5345 or phone (02)4844 5144

BARRIE PIGGOTT

PAINTER

PAINTING OF ALL TYPES OF RESIDENCES

(02) 4844 5389

Billabong, Cullulla Road, Tarago

Mobile: 0412 655 610

SUE'S PET MINDING SERVICE

Going away on holidays, a weekend away, or just need some-one to keep an eye on the place?

I can feed the animals, collect the mail, water the pot plants, even milk the house cow!

It's personalised service geared to what *you* need.

For further information:
telephone: Sue Carr on 48 444 364

MONEY GROWS ON TREES

Invest in
FARMFORESTRY,
CHRISTMAS TREES,

Plant a Pine Tree.

Pine Seedlings,
Superior Genetic Quality
25c each.

Discount on large orders

Delivery Arranged

Egaline Nursery

Tumbarumba. NSW

Ph 02 69485271

CARL ESTALL
"CARANE"

AUST STOCK HORSE STUD

HORSE SERVICES AVAILABLE
BREAKING IN, TRAINING & RETRAINING
TRANSPORT, FLOAT TRAINING,
PROBLEM HORSES CATERED FOR

YOUNG REG AUSTRALIAN STOCK HORSES
AVAILABLE FOR SALE

PHONE/FAX 0248) 444 225



★ DEVONSHIRE TEAS

★ LIGHT LUNCHES

★ COFFEE, TEA, COLD DRINKS

★ EAT IN OR TAKEAWAY

★ CRAFTS

★ COACH PARKING

★ SEATING FOR 50 PEOPLE

HOURS

Fri, Sat, Sun & Mon

Public Holidays • School Holidays

10am — 6pm

*Enquire about Group and
Pensioner discounts*

Cheryl Kennedy

4844 4392

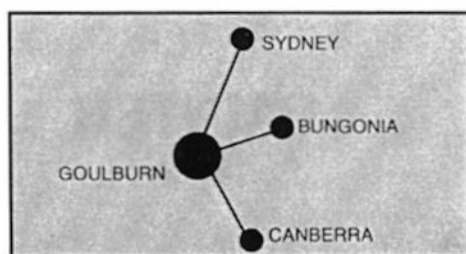

SEWING MACHINE REPAIRS

Repairs to all types of sewing machines.
Can do on site, call and pick up and delivery can
be arranged.

Opening Special: Clean and Checked \$25.00

Phone: 4844 4224 Fax: 4844 4363

All done by experienced Serviceman



BALYARTA PARK

Thoroughbred Stud

standing

BRAVE CENTURY (NZ)

- Spelling and Agistment at competitive rates.
- Complete Broodmare and Foal Care.
- Weaning, Breaking-in, Pre-training.
- Yearling Preparation.
- Dedicated, experienced staff, personalised and professional attention.
- Safe fencing, improved pastures.
- Inspection welcome by appointment.

For further enquiries please contact:

Cathy Hohos
"Balyarta Park"
Oallen Ford Rd, Bungonia, 2580

Phone / Fax: (02) 48444335 Mob: 0412 417 730

Compliments of

Jim Luce
Coogee Kelpie Stud

Coolabah Park
Bungonia. 2580

Phone/Fax 48 44 7151
Mobile 015 482 857



BUSINESS REQUISITES
SALES & SERVICE

- | | |
|------------------|----------------|
| • Photo Copiers | • Fax Machines |
| • Cash Registers | • Computers |
| • Stationery | • Consumables |

ROGER McLAUGHLIN

Owner/Manager

10 Russell Lane
Goulburn NSW 2580

Phone (02) 4821 5109
Fax (02) 4821 8229



Registered Boer Goat Stud
Boer Cross Meat Goats

Selling stud and commercial animals

Send for our free brochure
Getting into Goats for Meat

Visitors and enquiries welcome at any time

Jeremy, Robyn & Jeremy J. Badgery-Parker

'Kinvara' Marulan NSW 2579

Tel/Fax: (02) 4844 4243

Breeding Goats Since 1980

BUYING OR SELLING A HOUSE OR LAND?
See

JOHNSON & SENDALL

Incorporating Mullens
SOLICITORS - CONVEYANCERS

13 Montague Street
Goulburn NSW 2580
Phone: 48 211588
Fax: (048) 219850

Dick Peterswald
Morris Owen
Ian Cheetham
Tony Foley
Mark Bradbury
Meredith Paton

FOR ADVICE ON ALL YOUR
LEGAL REQUIREMENTS

BUNGONIA

Constructions

Quality Country Homes
Creative Design

WEEKENDERS
HOMESTEADS
LOFT HOMES
EXTENSIONS



TO LOCK UP OR TO COMPLETION

ALSO: SLABS & FOOTINGS, KIT HOME
AND SHED ERECTION, DECKS,
VERANDAHs, CARPORTS,
PERGOLAS, METAL ROOFING,
ALL CARPENTRY etc.

FOR ALL YOUR RURAL BUILDING NEEDS,
RING RALF

48 445 339

RALF DETJEN, WINDELLAMA ROAD,
BUNGONIA 2580 Lic.No: 28299C

CRESTWOOD PLANT HIRE

Phone 4844 7149



Backhoe Excavations
Depth to 5.40 metres

Bulldozer for Dams & Road Construction,
Clearing Levelling etc.

"CRESTWOOD VIEW"
BUNGONIA. 2580

DAVID BYRNE

GRANGER'S FREIGHT LINES

EXPRESS & GENERAL SERVICES
COVERING AUSTRALIA BY ROAD & AIR



Hugh Granger

Phone 48 21 3040
Fax (048) 21 9529

Oxley Street
GOULBURN 2580

Business Success Tips

- > Profit is the ultimate measure of business success.
- > Your team is your greatest asset, involve them.
- > Systemise the routine, humanise the exceptions.
- > Have a Customer First Focus. Nurture your existing customers.
- > It's the little things that make the difference in business.
- > Seek advice to improve decision making.
- > Unlock the hidden sales opportunities in your customer base.
- > Delegate work happily, delegate responsibility cautiously.

Peter Bugden FCA
Director

93 Bourke Street
Goulburn NSW 2580
P O Box 260, Goulburn NSW 2580

Phone: (02) 4822 2355 Fax: (02) 4822 4316
e-mail: bugden@acca.com.au Internet: <http://www.acca.com.au>

COMMISSO BUGDEN POWRIE

Chartered Accountants • Business Advisers • Tax Advisers



BRIAN'S AUTOSCREENS & GLASS

Mirrors - Showers - Mirror Wardrobes
Windscreens - Glass
Household Window Tinting

440 AUBURN ST. GOULBURN
Phone 48 21 2633...Fax 21 9133..

ACOM DESIGN

PO Box 806,
Goulburn 2580

Yarralla,
Oallen Ford Rd
Bungonia 2580

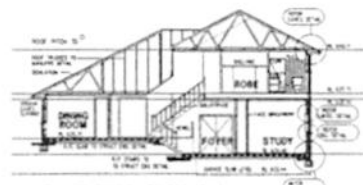

SECTIONAL ELEV A-A

Robert C Everingham

Building Designer & Draftsman

New Homes, Alterations & Additions
Duplex, Villa, Townhouse Developments
Rural, Commercial, Industrial Buildings
Free Quotes - Competitive Rates - Prompt Service
Energy Efficient (SEDA), Eng Dwgs: Mech, Struct, HVAC

TEL 4844 4321

MOBILE 0417 682 022

FAX 4844 4323

EMAIL acomdesign@bigpond.com.au



MEMBER
STANDARDS AUSTRALIA



MEMBER
BUILDING
DESIGNERS
ASSOCIATION
OF NEW SOUTH WALES INCORP

First Aid Instructor

CASSANDRA JENKINS

86 Gibson Street
Goulburn NSW 2580
Phone: (02) 4821 9986



First Aid Saves Lives..... Could you help someone in need?



40 years
experience

TRACTOR & MACHINERY REPAIRS

Very reasonable rates

Call Arthur Davey
4844 4242

If in doubt give Arthur a shout

Petal puzzle

Unscramble the five letters on each flower to make five words. Write the words in the grid on the flower pot. All the words are names of animals and the letters in the circles will reveal another animal.

